

Machetanz Elementary School

Schools on Trails: Chuqilntnu Creek Trail Nature Walk

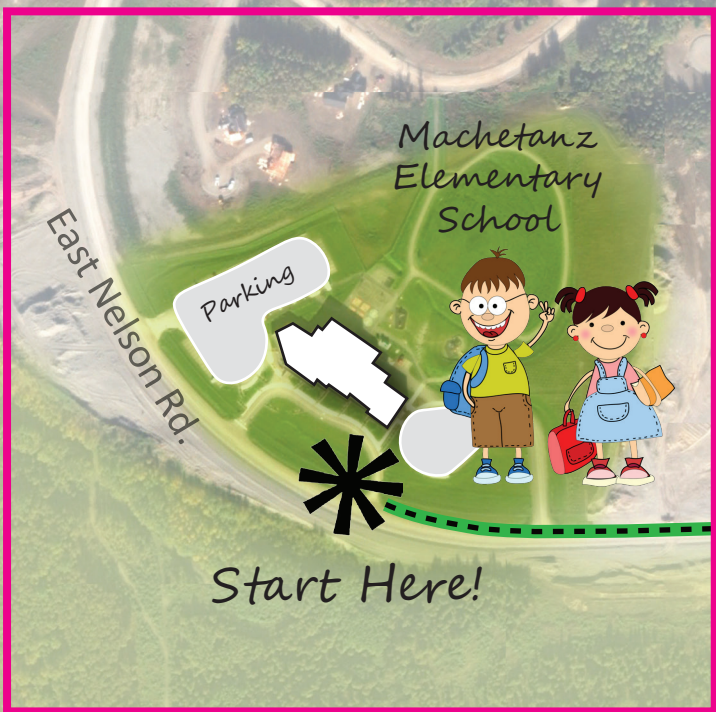

Caution!
No sidewalk

1 mile from Machetanz Elementary to Chuqilntnu Creek Trail

2110 steps



0.4 miles from trailhead to viewing platform

845 steps

Map Key

- Main Trail
- Wooden Boardwalk
- Metal Boardwalk
- Wetland Habitat

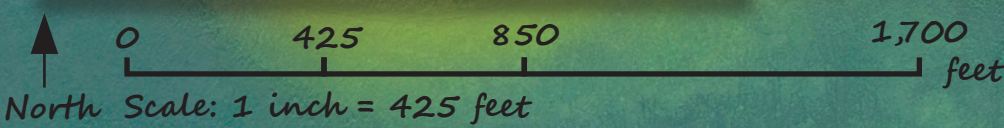

State Game Refuge

Palmer Hay Flats



Chugach Mountains



These maps were designed with the creative vision and artwork of Mrs. Riggan and Mrs. Brown's 2016-2017, 4th grade students.

The Machetanz Elementary connection to the Chuqilntnu Creek Trail is part of the Schools on Trails initiative to promote outdoor learning, student health and environmental education.

For more information visit www.anchorageparkfoundation.org/programs/schools-trails or contact Brendan at Brendan@AnchorageParkFoundation.org



Machetanz Elementary School

Schools on Trails: Chuqilntnu Creek Trail Nature Walk

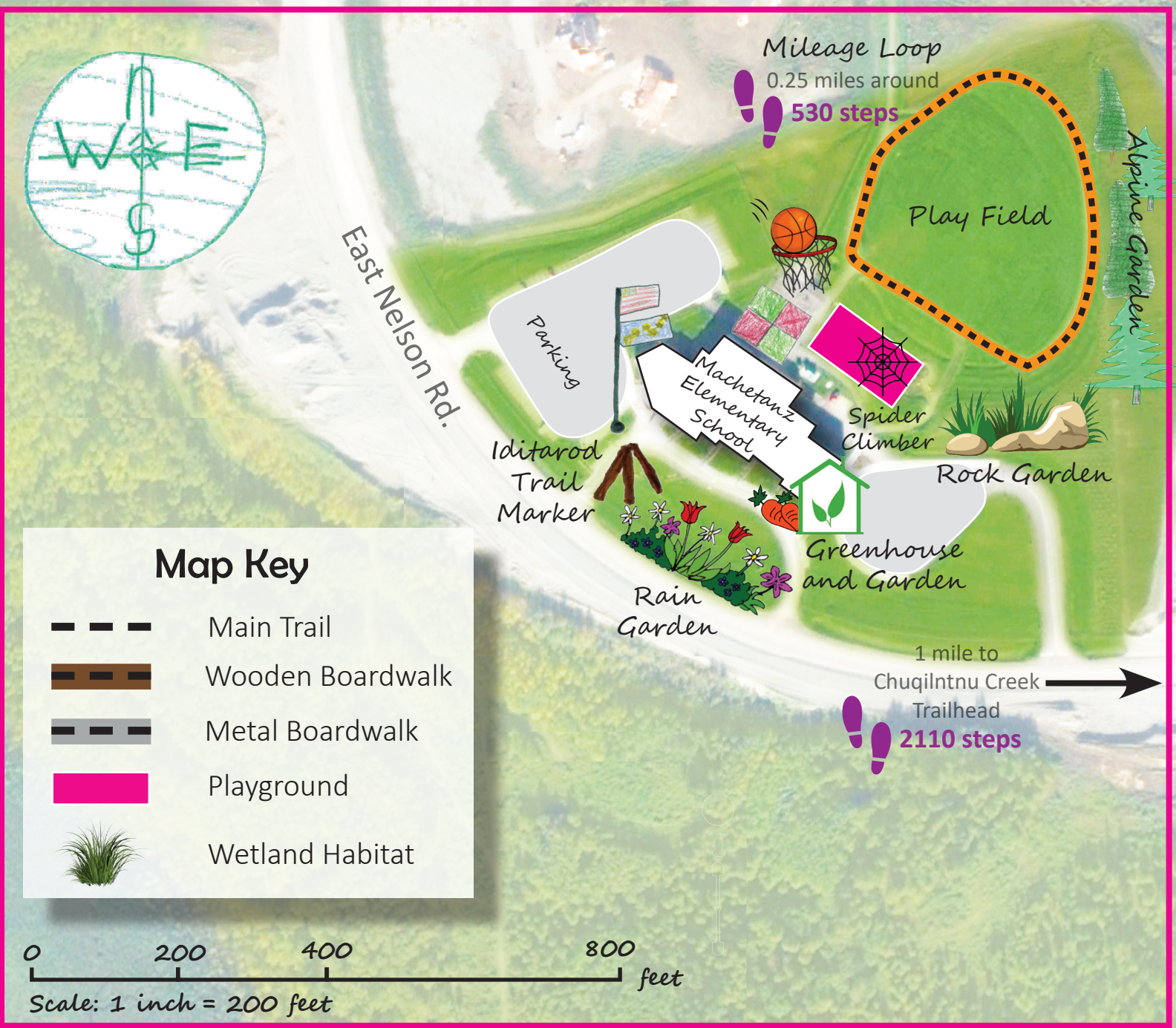

The Machetanz Elementary connection to the Chuqilntnu Creek Trail is part of the Schools on Trails initiative to promote outdoor learning, student health and environmental education.

For more information visit www.anchorageparkfoundation.org/programs/schools-trails or contact Brendan at Brendan@AnchorageParkFoundation.org

